





20 000 705

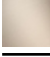

- diamètre de percement des robinets latéraux 32 mm
- rosace 60 x 60 mm
- avec marquage froid

| | | |
|---|-----------------------------|---------------|
|  | Platine brossé | 20 000 705-06 |
|  | Chrome | 20 000 705-00 |
|  | Dark Chrome | 20 000 705-19 |
|  | Champagne brossé (Or 22cts) | 20 000 705-46 |
|  | Champagne (Or 22cts) | 20 000 705-47 |
|  | Dark Platinum brossé | 20 000 705-99 |

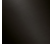
20 000 705

mm [inches]



Diagramme de débit



Certificats

IAPMO_4976 (5). WRAS_2103001. LGA_28688.

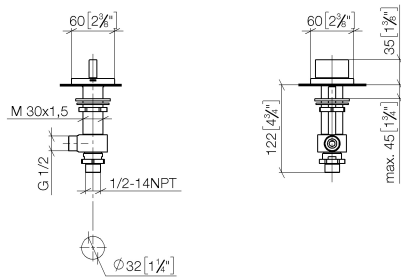
20 000 705

Les pièces pour les
autres finitions
peuvent être
trouvées ici : Chrome

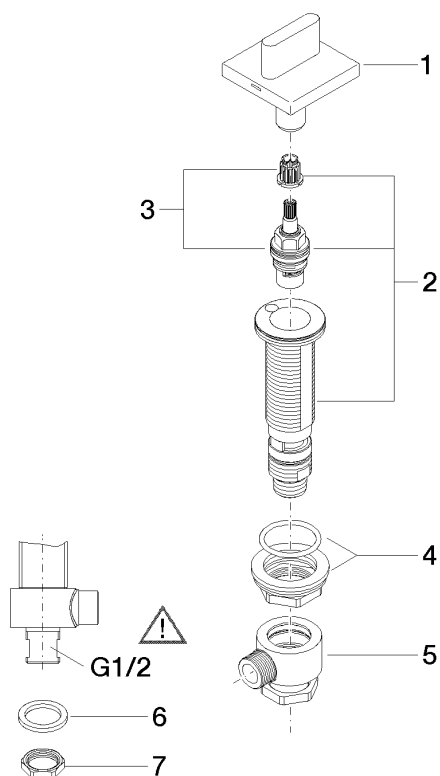

Liste des pièces de rechange

| N° | Article Numéro | Désignation | Fréquence de montage | Délai de livraison |
|----|--------------------|------------------|----------------------|--------------------|
| 1 | 90 20 70 051 04-06 | poignée (cold) | 1 | 10 |
| 2 | 04 17 11 058 33 90 | partie latérale | 1 | 2 |
| 3 | 90 90 03 133 00 90 | tête céramique | 1 | 2 |
| 4 | 04 23 10 032 78 90 | set de fixation | 1 | 2 |
| 5 | 04 17 11 023 10 90 | raccord multiple | 1 | 2 |
| 6 | 90 23 30 040 00-06 | joint américain | 1 | 10 |
| 7 | 09 30 11 059 90 | rondelle | 1 | 2 |
| 8 | 09 23 10 012 90 | écrou | 1 | 2 |